

CHAMBERLAIN®

LiftMaster®

PROFESSIONAL

MODELS • 902LM • 903LM

OWNERS INSTRUCTIONS

The two and three garage door multi-function control panel is designed to replace multiple door control buttons on LiftMaster Security+ garage door openers. It can be used as a replacement stand alone unit or in conjunction with the original factory door control buttons. Never connect more than two control panels or door control buttons to any one garage door opener.

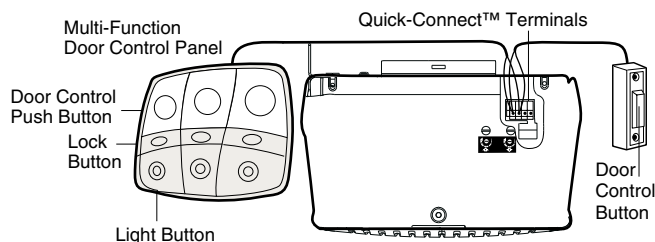

INSTALLATION

Product may be mounted directly to wall board or, for pre-wired installations (as in new home construction), it may be mounted to a single gang box. In either case the installation surface must be smooth and flat.

The door orientation goes from left to right, and wiring is as follows:

- **Left Door – Door A**
Wire white wire to White-1 and red/white wire to Red-1
- **Middle Door – Door B**
Wire white wire to White-2 and red/white wire to Red-2
Note: Model 902 LM will only have A and C terminals.
- **Right Door – Door C**
Wire white wire to White-3 and red/white wire to Red-3

NOTE: If replacing existing wall controls, labeling the existing wires with masking tape might be helpful (i.e. Door A, Door B, Door C).

1. Strip 7/16" of insulation from one end of bell wire and connect to the corresponding two screw terminal on back of door control by color. *Figure 1.* White to WHITE and red/white to RED. Be careful to wrap the exposed wire tightly around the screw and tighten. The exposed wire must not come into contact with exposed solder points. The Mylar insulator is there to prevent this from happening. Do not remove this insulator.
2. Run bell wire up wall and across ceiling to motor unit. Use insulated staples to secure wire in several places. Do not pierce wire with a staple, creating a short or open circuit.
3. Strip 7/16" of insulation from opposite end of bell wire. Connect bell wire to the Quick-Connect™ terminals located on garage door opener as follows: white to white and white/red to red. *Figure 5.*

NOTE: The door control button may stick if the door control is not mounted on a smooth surface. If a click is not heard when pressing the door control button, loosen the two mounting screws or relocate the door control to a smoother surface. After installation, an orange indicator light behind the door control buttons will indicate proper connection. If not lit, the Lock and Light features will not function (reverse wires to correct).

⚠ WARNING

To prevent possible SERIOUS INJURY or DEATH from electrocution:

- Be sure power is not connected BEFORE installing door control.
- Connect ONLY to 24 VOLT low voltage wires.

To prevent possible SERIOUS INJURY or DEATH from a closing garage door:

- Install door control within sight of garage door, out of reach of children at a minimum height of 5 feet, and away from all moving parts of door.
- NEVER permit children to operate or play with door control push buttons or remote control transmitters.
- Activate door ONLY when it can be seen clearly, is properly adjusted, and there are no obstructions to door travel.
- ALWAYS keep garage door in sight until completely closed. NEVER permit anyone to cross path of closing garage door.

Figure 1

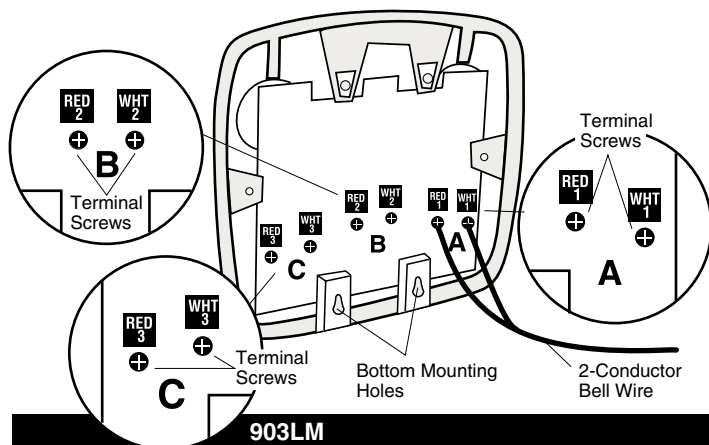
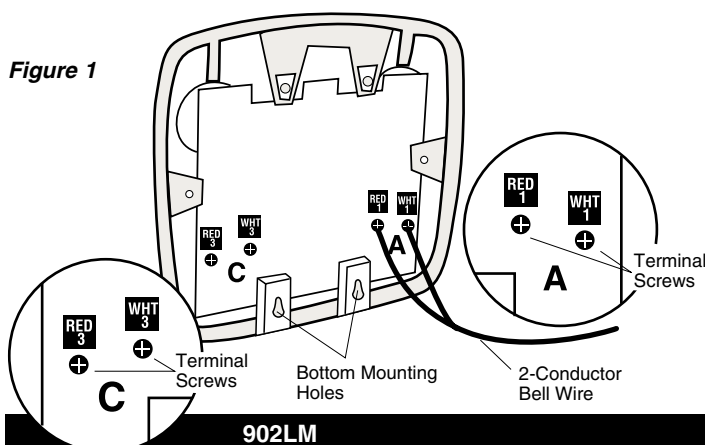
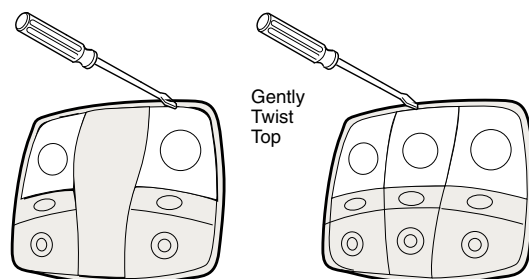

Figure 2



FOR WALL BOARD (DRYWALL) MOUNT

Remove the left and right door control buttons by gently twisting at the top with a small flat blade screwdriver exposing the horizontal installation holes. *Figure 2*. Mark and drill wall board. Drill 7/32" holes and use anchors provided. Fasten with 1-1/4" self-tapping screws. **Do not overtighten**. Insert bottom tabs and snap on door control buttons. *Figure 3*.

FOR MOUNTING ONTO A SINGLE ELECTRICAL GANG BOX

Remove the center cover or door control button by gently prying at slot in top of the door control button with a small flat blade screwdriver exposing two installation holes. *Figure 2*. For flexibility, this wall control can be mounted either left or right of center directly over gang box. Use 6-32X1" machine screws. Install bottom screw, allowing 1/8" to protrude above wall surface. Position bottom of door control on screw head and slide down to secure. Adjust screw for snug fit. Install matching top machine screw. **Do not overtighten**. Insert bottom tab and snap center cover or door control button. *Figure 4*.

NOTE: Mounting hardware is included for each type of installation (use all four screws if desired).

USING THE DOOR CONTROL

Press the door control button to open or close the door. Press again to reverse the door during the closing cycle or to stop the door while it's opening.

Light feature: Press the Light button to turn the opener light on or off. *Figure 6*. It will not control the opener lights when the door is in motion. If you turn it on and then activate the opener, the light will remain on for 4-1/2 minutes. Press again to turn it off sooner. On units that have the adjustable light feature the 4-1/2 minute interval can be changed to 1-1/2, 2-1/2, or 3-1/2 minutes as follows: Press and hold the Lock button until the light blinks (about 10 seconds). A single blink indicates that the timer is reset to 1-1/2 minutes. Repeat the procedure and the light will blink twice, resetting the timer to 2-1/2 minutes. Repeat again for a 3-1/2 minute interval, etc., up to a maximum of four blinks and 4-1/2 minutes.

Lock feature: Designed to prevent operation of the door from hand-held remote controls. However, the door will open and close from the Door Control, the Outside Keylock and the Keyless Entry Accessories.

To activate, press and hold the Lock button for 2 seconds. *Figure 6*. The door control button light will flash as long as the Lock feature is on.

To turn off, press and hold the Lock button again for 2 seconds. The door control button light will stop flashing. The Lock feature will also turn off whenever the "Smart" (learn) button on the motor unit panel is activated.

NOTE: The lock and light features will work properly on Security+ garage door openers manufactured after 1997.

For further product information refer to your owner's manual or go to www.liftmaster.com

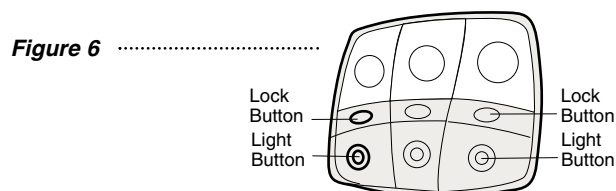
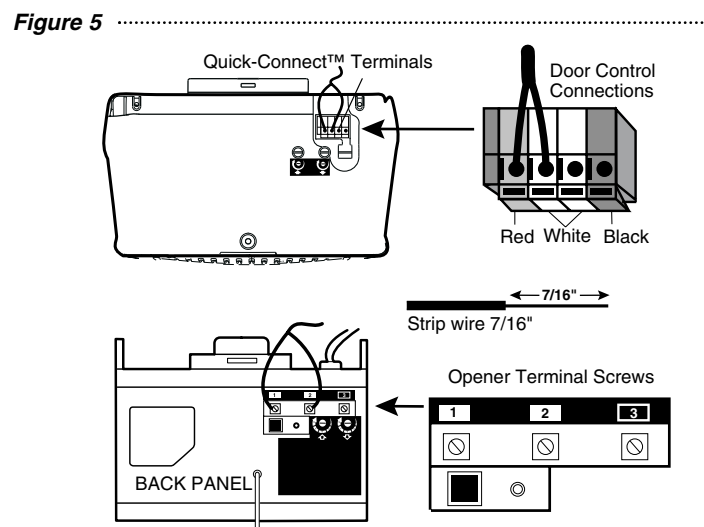
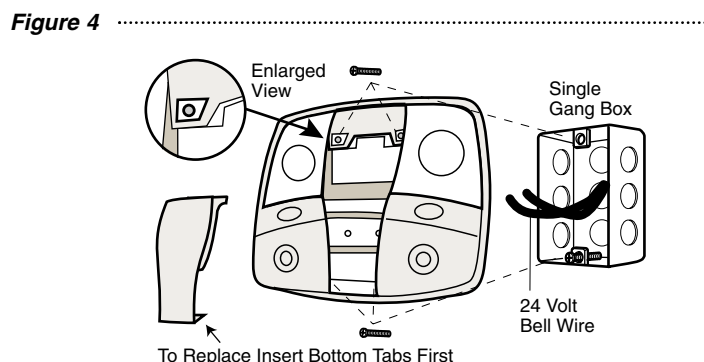
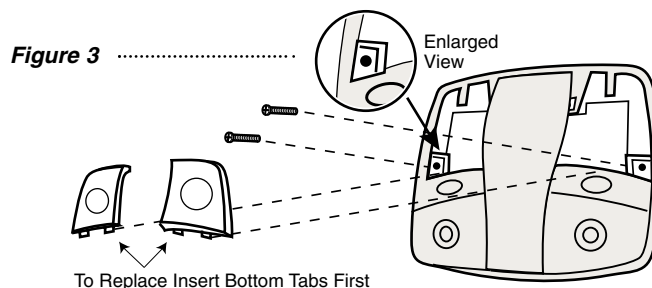

HOW TO ORDER REPAIR PARTS

DEK CANADA INC

1928 ST-REGIS BLVD.

DORVAL, QC

H9P 1H6

TEL: 514-685-5800

TOLL-FREE: 1-800-361-3198

FAX: 514-685-5804

www.dekcanada.com

**WHEN ORDERING REPAIR PARTS
PLEASE SUPPLY THE FOLLOWING INFORMATION:**

PART NUMBER	DESCRIPTION	MODEL NUMBER
--------------------	--------------------	---------------------