

# Installation Guide

# LiftMaster<sup>®</sup> TAC2C

**IMPORTANT:** The TAC2C has a Ringer Equivalence Number (REN) of 5 with a TELCO line and a REN of 3 without a TELCO line.

TAC1 RETROFIT KIT FOR CROWN JEWEL SYSTEMS

## Introduction

### CAUTION

DO NOT run data wires and HIGH VOLTAGE wires in the same conduit. The HIGH VOLTAGE wires may interfere with the data wires and cause the unit to malfunction. To AVOID damaging gas, power or other underground utility lines, contact underground utility locating companies BEFORE digging. To prevent damage to the unit:

- Use the new 12 Vac transformer ONLY.
- Use dedicated 110 Vac outlet ONLY.

### CARTON INVENTORY

- Hardware Bag  
**Complete with:** Hex Head Tamper Resistant Screws (4), Hex Tool (1), and Ground Lug (1)  
 Faceplate with Processor Board (1)  
 12 Volt AC 20VA Transformer (UL Listed) (1)  
 Install and Programming Guide (1)  
 Labels (9)

### SPECIFICATIONS

**Power Supply:** 12 Vac 20 VA

The 110 Vac outlet must be dedicated to the unit only. This outlet should be wired back to its own 10 Amp minimum circuit breaker. This will prevent two problems:

- Other equipment cannot introduce spikes, noise, surges, or dips into the power circuit.
- The unit's operation will not be affected if any other equipment develops a short circuit across the power line.

**Dimensions:** 9.72" x 6.22" (W x H)

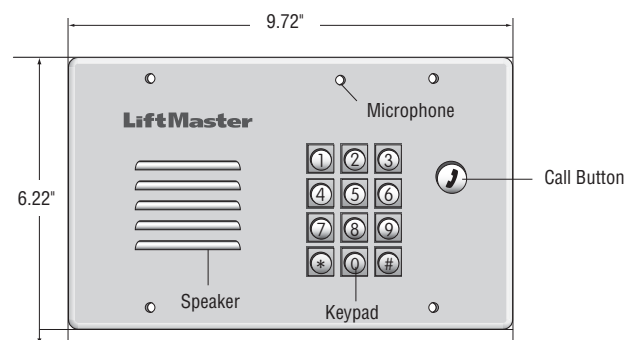

**1** Unplug the transformer from the outlet. Disconnect the wires from the existing transformer.

**IMPORTANT NOTE:** DO NOT use the existing transformer, the **provided transformer MUST be used instead.**

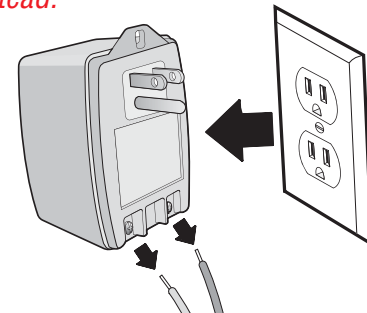

**2** Remove the screws from the Crown Jewel faceplate using the provided hex tool.

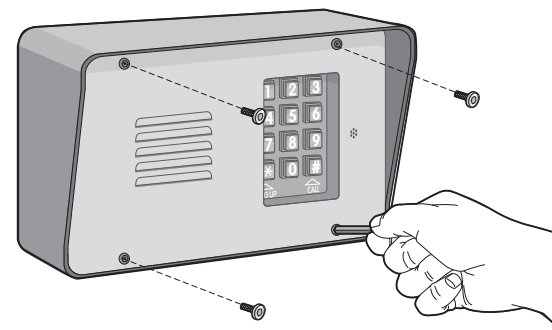

**3** Slide the faceplate forward and rotate downward.

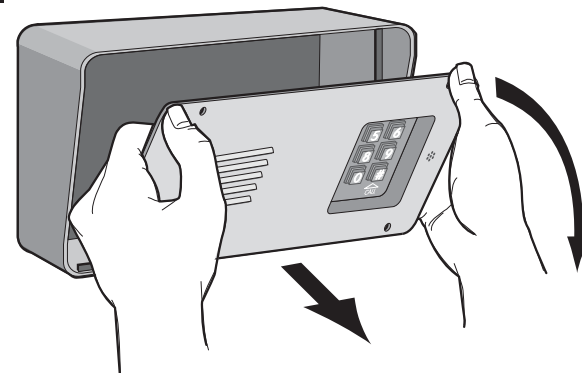

**4** Identify the terminal blocks on the Crown Jewel board. Attach the provided labels to the corresponding wires as shown. Once the wires are labeled, remove them from the board.

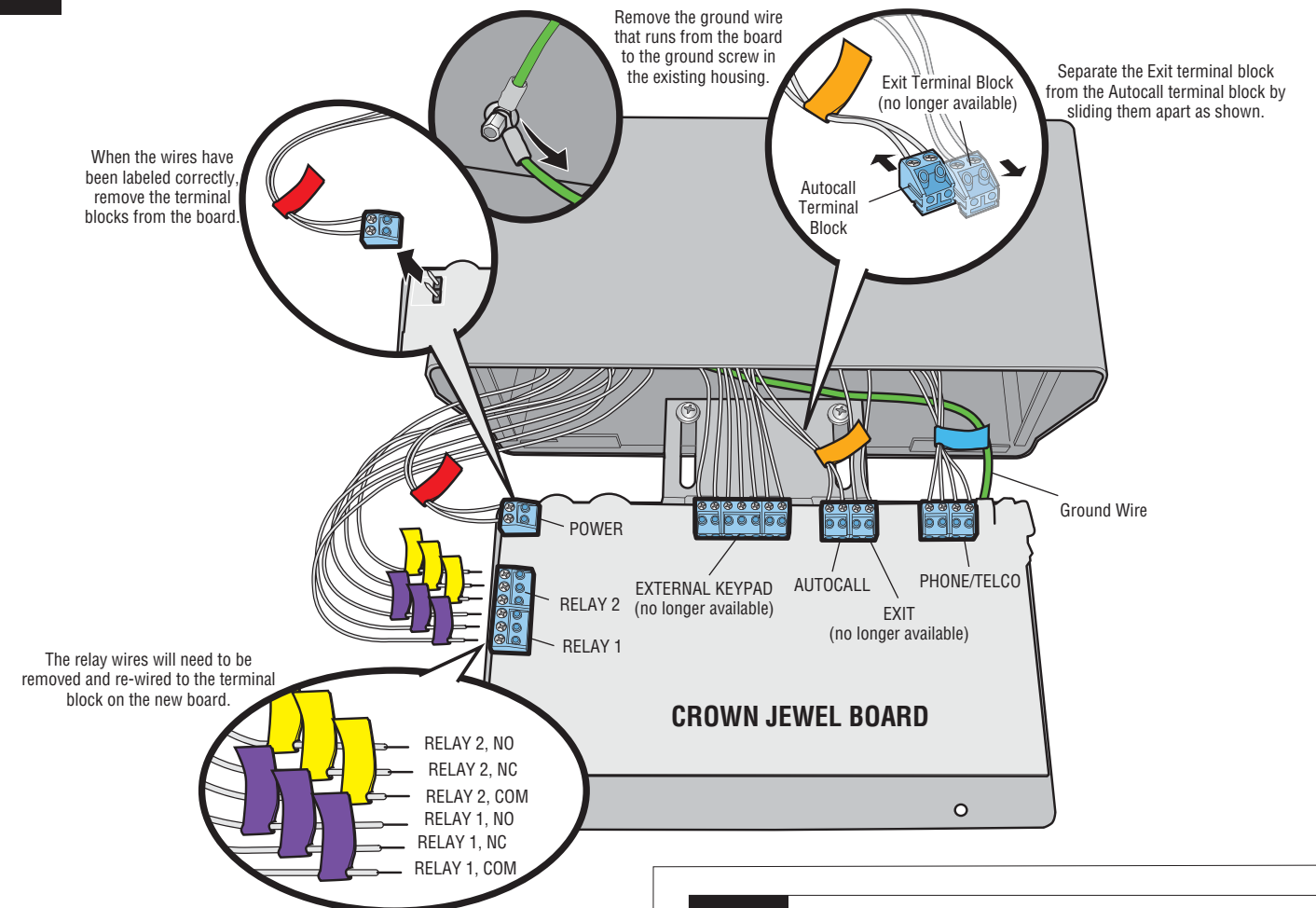

COLOR	LABEL	DESCRIPTION
Red	POWER	12 volt AC power input
Orange	AUTOCALL	Input for accessory device to trigger home dialing
Blue	PHONE/TELCO	Input connection for TELCO
Yellow	RELAY 2, NO	NO input for Relay 2
Light Yellow	RELAY 2, NC	NC input for Relay 2
Yellow	RELAY 2, COM	COM input for Relay 2
Purple	RELAY 1, NO	NO input for Relay 1
Light Purple	RELAY 1, NC	NC input for Relay 1
Purple	RELAY 1, COM	COM input for Relay 1

**5** Remove the screws (2) securing the faceplate to the housing.

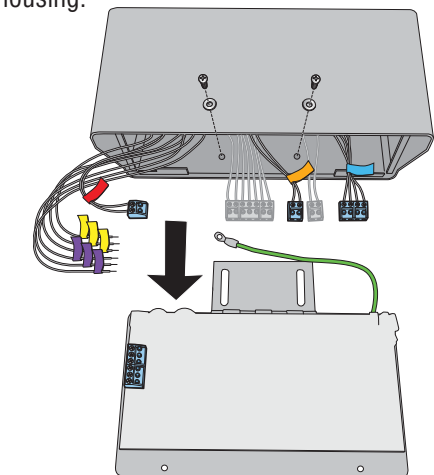

# 6

Attach the labeled wires to the new TAC2C board as shown.

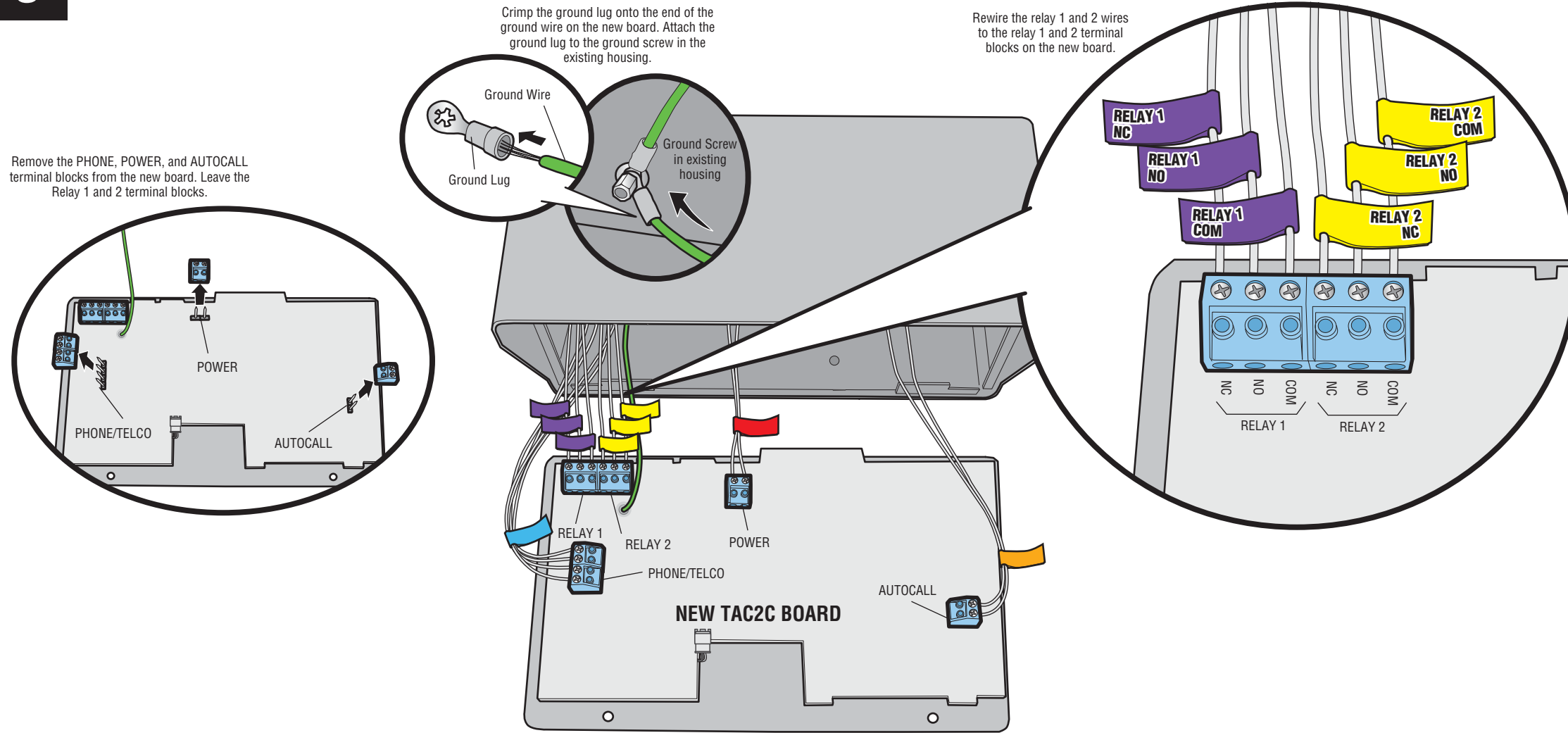

# 7

When wiring is complete, secure the new faceplate to the existing housing with the provided screws (4).

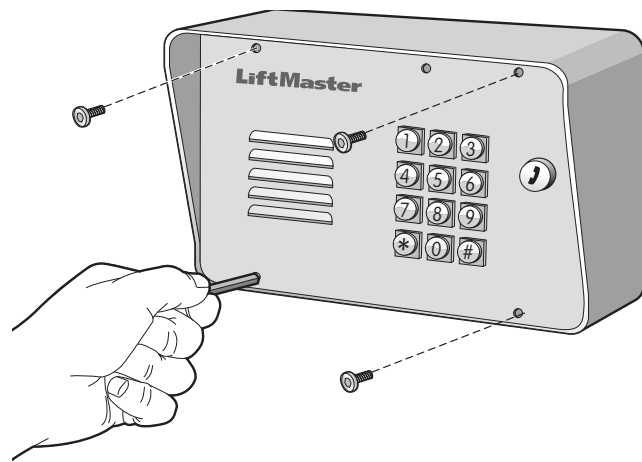

# 8

Connect the power wires to the new transformer and plug the transformer into a 110 Vac outlet ONLY, any other type of outlet will cause damage to the unit.

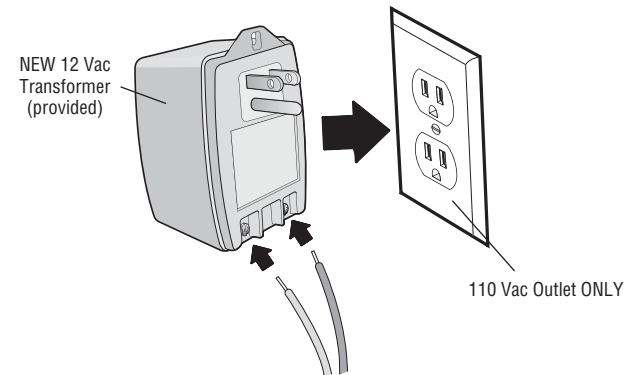

**IMPORTANT NOTE:** DO NOT use the existing transformer, the **provided** transformer **MUST** be used instead.

# 9

## SET THE MASTER CODE

Once power is applied, the unit will begin to “click” to indicate that it is powered, and is waiting to be programmed for the unit’s Master Code. The Master Code is used to unlock the programming functions of the unit. The Master Code should not be distributed as a User Code.

1 Enter    on the unit’s keypad.

2 Enter 4-digit Master Code. Example: 1234.



“BEEP” “BEEP”

3 Write down the Master Code and store in a secure location.



# Testing

## TEST GATE / DOOR RELAYS

### Test Relay 1

1 Enter 4 digit Master Code.



2 Press 1 to test Relay 1.



### Test Relay 2

1 Enter 4 digit Master Code.



2 Press 2 to test Relay 2.



## TEST THE TELEPHONE CONNECTIONS

1 Place a telephone call from the resident’s telephone to verify the unit is operating properly, then hang up the phone.

2 Press the “Call” button on the unit’s keypad. The telephone in the residence should ring.



3 To test Relay 1 have someone answer the telephone and enter “\*9” (Star + 9) to activate Relay 1. The unit will disconnect the call as soon as the relay is activated. To test Relay 2 have someone answer the telephone and enter “\*5” (Star + 5). Relay 2 should activate. The unit will disconnect the call as soon as the relay is activated.

# LiftMaster®

## TAC2C

TAC1 RETROFIT KIT FOR CROWN JEWEL SYSTEMS



### *Programming Guide*

# PROGRAMMING » KEYPAD

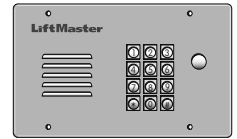

**NOTE:** Use the STAR Key "\*" to cancel any input.

PROGRAMMING INSTRUCTION	SYNTAX	KEYSTROKES
General Programming	Master Code + Command	1234 + 1 (12,123)
Code Programming	Master Code + Command + Code	1234 +1(12) + 1234
Relay Programming	Master Code + Command + Setting	1234 + 123 + 1234
Level Adjustment	Master Code + Command + Setting	1234 + 12 + 1-3

**NOTE:** Keypad commands are to be entered in a single string to result in success (indicated by double high success tone). Stop and go keystrokes will result in negative tones (low single and triple fail tones).

### CHANGE THE MASTER CODE

1. Enter the Master Code: [?] [?] [?] [?]
2. Enter the Program Code: [0] [9] The unit will beep.
3. Enter: [#] [#] [#]
4. Enter the new Master Code: [?] [?] [?] [?]  
The unit will beep.

**Write down the Master Code and store in a secure location.**

### ENABLE TELCO MODE

Telco Mode is using the main telephone line for the unit's communications to the house or complex.

1. Enter the Master Code: [?] [?] [?] [?]
2. Enter the Program Code: [0] [4]

### ENABLE INTERCOM (NO TELCO) MODE

1. Enter the Master Code: [?] [?] [?] [?]
2. Enter the Program Code: [0] [3]

### MICROPHONE SENSITIVITY

Allows the resident to hear the visitor at the unit, 1 = Low, 2 = Medium and 3 = High. **Default level is 2.**

1. Enter the Master Code: [?] [?] [?] [?]
2. Enter the Program Code: [0] [7]
3. Enter the Volume Level: [1] or [2] or [3]

### SPEAKER VOLUME

Allows the visitor to hear the resident at the unit, 1 = Low, 2 = Medium and 3 = High. **Default level is 2.**

1. Enter the Master Code: [?] [?] [?] [?]
2. Enter the Program Code: [0] [6]
3. Enter the Volume Level: [1] or [2] or [3]

### ENABLE PARALLEL RELAY OUTPUT (DEFAULT)

1. Enter the Master Code: [?] [?] [?] [?]
2. Enter the Program Code: [0] [2] [1]

### ENABLE INDEPENDENT RELAY OUTPUT CONTROL

1. Enter the Master Code: [?] [?] [?] [?]
2. Enter the Program Code: [0] [2] [3]

### ADJUST RELAY OUTPUT TIME (RELAY 1)

The amount of time (in seconds) the relay remains active. Default level is 0.5 seconds.

1. Enter the Master Code: [?] [?] [?] [?]
2. Enter the Program Code: [0] [2] [4]
3. Enter the Output Time (in seconds): [?] [?] [?] [?]  
Example:  
0000 = 0.5 Seconds (Minimum)  
0010 = 10 Seconds  
8000 = 8000 Seconds (Maximum)

### ADJUST RELAY OUTPUT TIME (RELAY 2)

The amount of time (in seconds) the relay remains active. Default level is 0.5 seconds.

1. Enter the Master Code: [?] [?] [?] [?]
2. Enter the Program Code: [0] [2] [5]
3. Enter the Output Time (in seconds): [?] [?] [?] [?]  
Example:  
0000 = 0.5 Seconds (Minimum)  
0010 = 10 Seconds  
8000 = 8000 Seconds (Maximum)

# PROGRAMMING » KEYPAD

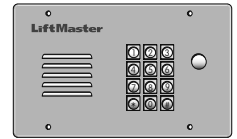

## CODE SETUP

The unit's Master Code is for owner/administrator level commands. The User Codes allow users to activate and latch relays 1 and 2.

**NOTE:** The User Code cannot be the same as the Master Code.

### ENTER A USER CODE NUMBERS

1. Enter the Master Code:     The unit will beep.
2. Enter the Program Code:  The unit will beep.
3. Enter New User Code:
4. Enter the Relay for the Code to control:  or  or no button is pressed.

**NOTE:** If no button is pressed in step 4, both relays will activate simultaneously.

### DELETE USER CODE NUMBERS

1. Enter the Master Code:     The unit will beep.
2. Enter the Program Code:  The unit will beep.
3. Enter User Code to be deleted:

## CODE OPERATION

### MASTER CODE OPERATIONS

#### TRIGGER RELAY 1 (ONLY)

Enter the Master Code:

**NOTE:** Requires Relay 2 be in Independent Mode.

#### ENABLE VACATION (LOCK DOWN) MODE

Locks the unit from all User Code activity.

1. Enter the Master Code:
2. Enter the Program Code:

#### DISABLE VACATION (LOCK DOWN) MODE

1. Enter the Master Code:
2. Enter the Program Code:

#### TRIGGER RELAY 1

1. Enter the Master Code:
2. Enter the Program Code:

#### TRIGGER RELAY 2

1. Enter the Master Code:
2. Enter the Program Code:

### USER CODE OPERATIONS

#### TRIGGER PROGRAMMED RELAY FOR USER CODE

Enter the User Code:

The Relay will activate.

#### ENTER A TEMPORARY (1 SHOT) USER CODE NUMBER

The unit holds 1 temporary User Code.

1. Enter the Master Code:
2. Enter the Program Code:   The unit will beep.
3. Enter the Temporary User Code:
4. Enter the Relay for the Code to control:  or  or no button is pressed.

**NOTE:** If no button is pressed in step 4, both relays will activate simultaneously.

#### ENGAGE PARTY MODE (RELAY 1)

Party Mode will latch relay.

1. Enter the Master Code:
2. Enter the Program Code:

To disengage party mode: Enter a valid code into the keypad or enter "\*9" into the local telephone.

#### ENGAGE PARTY MODE (RELAY 2)

Party Mode will latch relay.

1. Enter the Master Code:
2. Enter the Program Code:

To disengage party mode: Enter a valid code into the keypad or enter "\*5" into the local telephone.

# PROGRAMMING » TELEPHONE



## TELEPHONE PROGRAMMING

### ENABLE INTERCOM MODE

Enter the command tone: \* \* 0 3

### ENABLE TELCO MODE

Enter the command tone: \* \* 0 7

### ENABLE STANDARD (LONG) RING TONE

Enter the command tone: \* \* 1 4

### ENABLE ALTERNATE (DUAL) RING TONE (DEFAULT)

Enter the command tone: \* \* 1 5

### ADJUST "PICK UP" RING COUNT

1. Enter the command tone: \* \* 1 0

2. Enter the ring count: 2 through 5

### ENABLE ALTERNATE DTMF PROGRAMMING

This feature changes the first programming digit from

\* to #

Enter the command tone: \* \* 1 3

### DISABLE ALTERNATE DTMF PROGRAMMING

Enter the command tone: # \* 1 6

## CALL FORWARDING

### ENTER CALL FORWARDING TELEPHONE NUMBER

Enter the command tone:

\* # [Up to a 14 Digit Telco Number] #

### ERASE THE CALL FORWARDING NUMBER

Enter the command tone: \* \* # 8

### VERIFY CALL FORWARDING NUMBER (VIA CALLER ID)

Enter the command tone: \* \* 0 6

Hang up the phone - Wait for the ring.

### ENABLE CALL FORWARDING

Enter the command tone: \* \* 0 1

### DISABLE CALL FORWARDING

Enter the command tone: \* \* 0 2

## TELEPHONE COMMANDS

### FROM LOCAL TELEPHONE

#### TRIGGER RELAY 1

Enter the command tone: \* 9

#### TRIGGER RELAY 2

Enter the command tone: \* 5

#### DISABLE "DO NOT DISTURB" MODE

Enter the command tone: \* \* 1 2

#### ENABLE PARTY MODE (RELAY 1)

Enter the command tone: \* \* 0 4

To disengage party mode: Enter "\*9" into the local telephone.

#### ENABLE "DO NOT DISTURB" MODE

Enter the command tone: \* \* 1 1

### FROM FORWARDED TELEPHONE

#### ACCEPT CALL FROM UNIT ON REMOTE TELEPHONE

Enter the command tone: 0

#### TRIGGER RELAY 1

Enter the command tone: \* 9

#### TRIGGER RELAY 2

Enter the command tone: \* 5

# PROGRAMMING » QUICK REFERENCE

## KEYPAD PROGRAMMING

PROGRAMMING NUMBER	DESCRIPTION OF TASK	FACTORY SETTING	PROGRAMMING PROCEDURE
1	Trigger Relay One		Master Code (4 digits) + 1
2	Trigger Relay Two		Master Code (4 digits) + 2
7	Delete User Code		Master Code (4 digits) + 7 + User Code that is to be deleted (4 digits)
9	Enter User Code		Master Code (4 digits) + 9 + New User Code (4 digits) + Relay Associated with the User Code (1 or 2)
03	Enable Intercom (No-Telco) Mode	Enabled	Master Code (4 digits) + 03
04	Enable Telco Mode		Master Code (4 digits) + 04
06	Speaker Volume	Level 2	Master Code (4 digits) + 06 + Volume Level (1 = Low, 2 = Medium or 3 = High)
07	Microphone Sensitivity	Level 2	Master Code (4 digits) + 07 + Volume Level (1 = Low, 2 = Medium or 3 = High)
09	Change the Master Code		Master Code (4 digits) + 09 + ### + New Master Code (4 digits)
51	Create Temporary (1 Shot) Code		Master Code (4 digits) + 51 + New Temporary (1 Shot) Code (4 digits) + Relay Associated with the User Code (1 or 2)
52	Enable Vacation (Lock Down) Mode	Disabled	Master Code (4 digits) + 52
53	Disable Vacation (Lock Down) Mode		Master Code (4 digits) + 53
54	Engage Party Mode (Relay 1)	Disabled	Master Code (4 digits) + 54
56	Engage Party Mode (Relay 2)	Disabled	Master Code (4 digits) + 56
021	Enable Parallel Relay Output	Enabled	Master Code (4 digits) + 021
023	Enable Independent Relay Output Control	Disabled	Master Code (4 digits) + 023
024	Adjust Relay Output Time (Relay 1)	.5 Seconds	Master Code (4 digits) + 024 + Relay Output Time (0000-8000 Seconds) <b>NOTE: Relay output time is ALWAYS 4 digits.</b>
025	Adjust Relay Output Time (Relay 2)	.5 Seconds	Master Code (4 digits) + 025 + Relay Output Time (0000-8000 Seconds) <b>NOTE: Relay output time is ALWAYS 4 digits.</b>

## DIRECT COMMANDS FROM THE UNIT KEYPAD

KEYSTROKES	ACTION
User Code + 1	Triggers Relay 1
User Code + 2	Triggers Relay 2

### AUDIO FEEDBACK FROM THE UNIT:

1 Low Tone = Failure

2 Tone Beep = Valid sequence

3 Tone Beep = Error or invalid sequence

**NOTE:** Use the STAR Key "\*" to cancel any input.

**NOTE:** Keypad commands are to be entered in a single string to result in success (indicated by double high success tone). Stop and go keystrokes will result in negative tones (low single and triple fail tones).

# PROGRAMMING » QUICK REFERENCE

## TELEPHONE PROGRAMMING

PROGRAMMING NUMBER	DESCRIPTION OF TASK	FACTORY SETTING	PROGRAMMING PROCEDURE
**01	Enable Call Forwarding	Disabled	**01
**02	Disable Call Forwarding		**02
**03	Enable Intercom Mode	Disabled	**03
**06	Verify Call Forwarding Number (Via Caller ID)	Disabled	**06
**07	Enable Telco Mode	Disabled	**07
**#8	Erase Call Forwarding Number		**#8
**10	Adjust "Pick-Up" Ring Count		**10 + Ring Count (2-5)
**13	Enable Alternate DTMF Programming	Disabled	**13
**14	Enable Standard (Long) Ring Tone		**14
**15	Enable Alternate (Dual) Ring Tone	Enabled	**15
#*16	Disable Alternate DTMF Programming		**16
*# Call Forwarding Number #	Enter Call Forwarding Telephone Number		*# + Telephone Number (Up to 14 digits) + #

### MASTER CODE NUMBER

Write down the Master Code and store in secure location.

--	--	--	--



# PROGRAMMING » RESIDENT INSTRUCTIONS FOR TAC MODELS

## DIRECT COMMANDS FROM THE LOCAL TELEPHONE

Direct commands allow you to control the unit from the resident telephone. To use direct commands lift the handset, wait for dial tone and enter the direct command.

PROGRAMMING NUMBER	DESCRIPTION OF TASK	FACTORY SETTING	PROGRAMMING PROCEDURE
*5	Triggers Relay 2		*5
*9	Triggers Relay 1		*9
**04	Enable Party (Latched) Mode Relay 1		**04
**05	Disable Party (Latched) Mode Relay 1		
**11	Enable "Do Not Disturb" Mode	Disabled	**11
**12	Disable "Do Not Disturb" Mode		**12

## ANSWERING A CALL FROM A VISITOR

To answer a call lift the handset. To control the gate press "\*9" or "\*5".

## ANSWERING CALLS FROM A REMOTE TELEPHONE

When a call is answered from a remote telephone a beep will be heard for 10 seconds. To accept the call press "0". Hang up to disconnect. To control the gate press "\*9" or "\*5".

PROGRAMMING NUMBER	DESCRIPTION OF TASK	FACTORY SETTING	PROGRAMMING PROCEDURE
0	Accepts Call From The Unit		0
*5	Triggers Relay 2		*5
*9	Triggers Relay 1		*9

**NOTE:** Use the STAR Key "\*" to cancel any input.

**NOTE:** Keypad commands are to be entered in a single string to result in success (indicated by double high success tone). Stop and go keystrokes will result in negative tones (low single and triple fail tones).

# LIMITED WARRANTY

The Chamberlain Group, Inc. ("Seller") warrants to the first purchaser of this product, for the structure in which this product is originally installed, that it is free from defect in materials and/or workmanship for a period of one year from the date of purchase.

The proper operation of this product is dependent on your compliance with the instructions regarding installation, operation, maintenance and testing. Failure to comply strictly with those instructions will void this limited warranty in its entirety.

If, during the limited warranty period, this product appears to contain a defect covered by this limited warranty, call 1-800-528-2806 before dismantling this product. Then send this product, pre-paid and insured, to our service center for warranty replacement. Products returned to Seller for warranty replacement, which upon receipt by Seller are confirmed to be defective and covered by this limited warranty, will be replaced (at Seller's sole option) at no cost to you and returned pre-paid. Defective parts will be replaced with new or factory-rebuilt parts at Seller's sole option.

THIS LIMITED WARRANTY IS IN LIEU OF ANY OTHER WARRANTIES, EXPRESS OR IMPLIED, INCLUDING ANY IMPLIED WARRANTY OF MERCHANTABILITY OR FITNESS FOR A PARTICULAR PURPOSE OR OTHERWISE, AND OF ANY OTHER OBLIGATIONS OR LIABILITY ON SELLER'S PART. THIS LIMITED WARRANTY DOES NOT COVER NON-DEFECT DAMAGE, DAMAGE CAUSED BY IMPROPER INSTALLATION, OPERATION OR CARE (INCLUDING, BUT NOT LIMITED TO ABUSE, MISUSE, FAILURE TO PROVIDE REASONABLE AND NECESSARY MAINTENANCE, UNAUTHORIZED REPAIRS OR ANY ALTERATIONS TO THIS PRODUCT), LABOR CHARGES FOR REINSTALLING A REPAIRED OR REPLACED UNIT, PROBLEMS RELATED TO INTERFERENCE, OR REPLACEMENT OF BATTERIES.

UNDER NO CIRCUMSTANCES SHALL SELLER BE LIABLE FOR CONSEQUENTIAL, INCIDENTAL OR SPECIAL DAMAGES ARISING IN CONNECTION WITH USE, OR INABILITY TO USE, THIS PRODUCT. IN NO EVENT SHALL SELLER'S LIABILITY FOR BREACH OF WARRANTY, BREACH OF CONTRACT, NEGLIGENCE OR STRICT LIABILITY EXCEED THE COST OF THE PRODUCT COVERED HEREBY. NO PERSON IS AUTHORIZED TO ASSUME FOR US ANY OTHER LIABILITY IN CONNECTION WITH THE SALE OF THIS PRODUCT.

Some states do not allow the exclusion or limitation of consequential, incidental or special damages, so the above limitation or exclusion may not apply to you. This limited warranty gives you specific legal rights, and you may also have other rights which vary from state to state.

**DEK CANADA INC**  
**1928 ST-REGIS BLVD.**  
**DORVAL, QC**  
**H9P 1H6**

**TEL: 514-685-5800**  
**TOLL-FREE: 1-800-361-3198**  
**FAX: 514-685-5804**

**[www.dekcanada.com](http://www.dekcanada.com)**

NOTICE: To comply with FCC and or Industry Canada rules (IC), adjustment or modifications of this receiver and/or transmitter are prohibited, except for changing the code setting or replacing the battery. THERE ARE NO OTHER USER SERVICEABLE PARTS.

Tested to Comply with FCC Standards FOR HOME OR OFFICE USE. Operation is subject to the following two conditions: (1) this device may not cause harmful interference, and (2) this device must accept any interference received, including interference that may cause undesired operation.